

APPROVED BY: _____
 DATE : _____

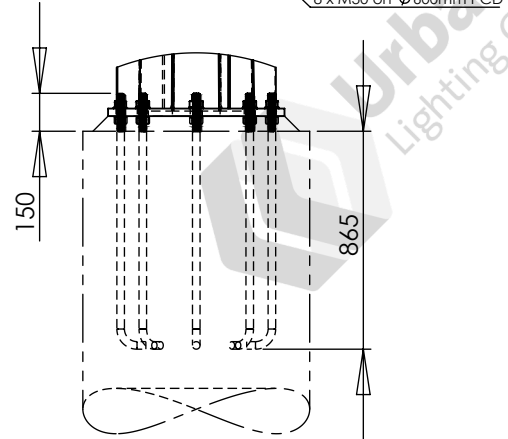
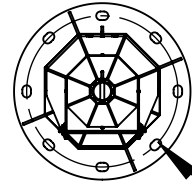
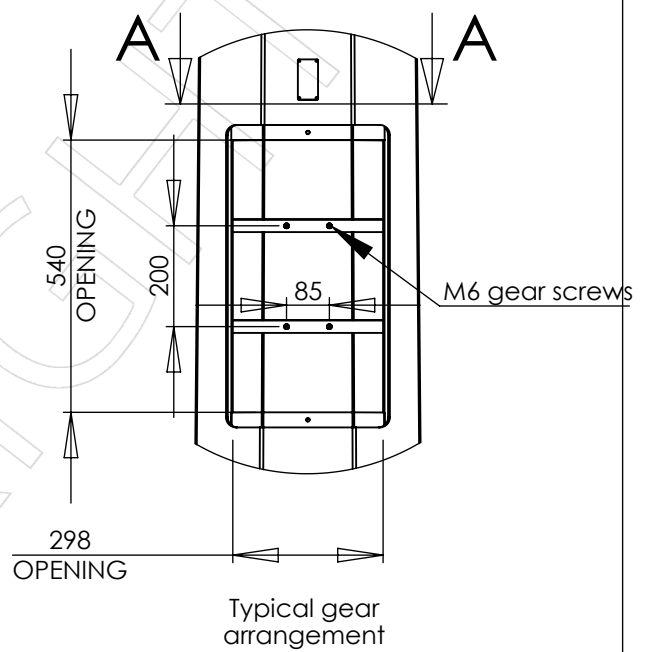
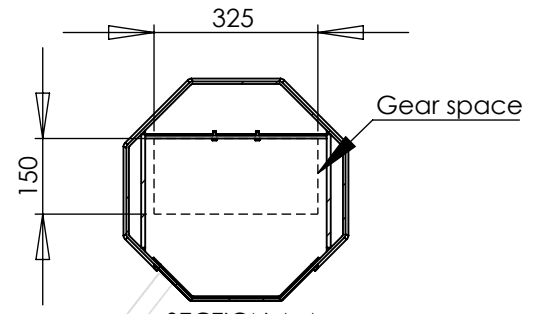
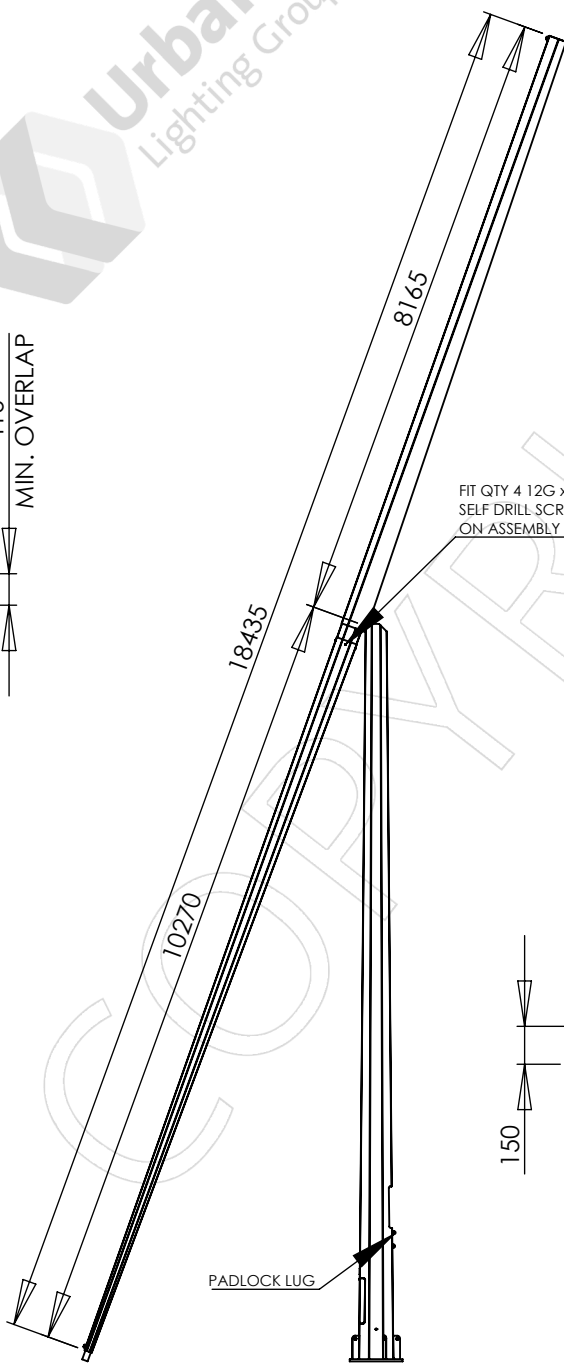
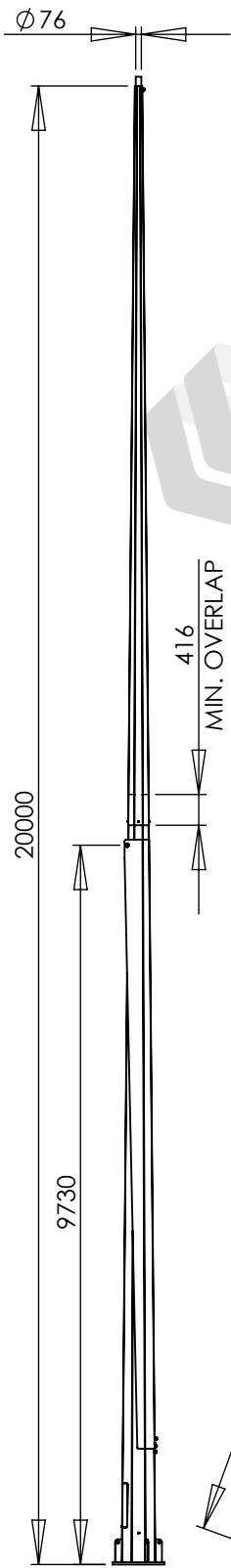

Notes:
 1. Luminaires and cabling are not included unless specifically listed on the quotation.
 2. See quotation for reinforcing cage and footing details

Designed and manufactured to:
 AS 1798 Lighting poles and arms - Preferred dimensions
 AS/NZS 1170.2 Structural design actions - Part 2: Wind actions
 AS 4100 Steel structures
 AS 4680 Hot-dip galvanized (zinc) coatings
 See DS-3040 for other design standards

PARTS LIST					
ITEM NO.	PART NUMBER	DESCRIPTION	DRAWING NO.	REV.	QTY.
1	FL20MH20-120	COLUMN, 20.0m 2 SECTION 8 SIDED MID-HINGED	ADL-21611	1	1
2	FBA-8XM30X600	FOUNDATION BOLT ASSEMBLY, 8 x M30 ON 600mm PCD			1

REV.	DESCRIPTION	DATE	BY	APP.
1	INITIAL ISSUE	2024-02-08	KG	ME

COLUMN, FL20MH20-120, 20.0m 8 SIDED MID-HINGED 20kg - 120kg	
COATING:	
MAXIMUM LOAD: 1.2m ² 120kg	
WIND REGION: A, TC 2	GROUND LOAD: M* 111 kNm, V* 10.5 kN
WEIGHT: 1050kg	DO NOT SCALE

Urban Lighting Group
 Innovative Streetscape Solutions

Urban Lighting Group Pty Ltd
 ABN 74 638 077 684
 28 National Drive, Hallam Victoria 3803
 T 1300 088 719
 email: sales@urbanlightinggroup.com.au

DRAWING NO. GA-10835
 REVISION 1

BALANCE WEIGHTS		
TOP LOAD	WEIGHTS	
20kg	NONE	0kg
22kg	BW450-2	2kg
24kg	BW450-3 BW450-1	5kg
26kg	BW450-4	8kg
28kg	BW450-4 BW450-2 BW450-1	11kg
30kg	BW450-4 BW450-3 BW450-1	13kg
32kg	BW450-5	16kg
34kg	BW450-5 BW450-2 BW450-1	19kg
36kg	BW450-5 BW450-3 BW450-2	22kg
38kg	BW450-5 BW450-4	24kg
40kg	BW450-5 BW450-4 BW450-2 BW450-1	27kg
45kg	BW450-5 BW450-5 BW450-2	34kg
50kg	BW450-5 BW450-5 BW450-4 BW450-1	41kg
55kg	BW450-5 BW450-5 BW450-5	48kg
60kg	BW450-5 BW450-5 BW450-5 BW450-3 BW450-2 BW450-1	55kg

BALANCE WEIGHTS		
TOP LOAD	WEIGHTS	
65kg	BW450-5 BW450-5 BW450-5 BW450-4 BW450-3 BW450-2	62kg
70kg	BW450-5 BW450-5 BW450-5 BW450-5 BW450-3 BW450-1	69kg
75kg	BW450-5 BW450-5 BW450-5 BW450-5 BW450-4 BW450-2 BW450-1	75kg
80kg	BW450-5 BW450-5 BW450-5 BW450-5 BW450-5 BW450-2	82kg
85kg	BW450-5 BW450-5 BW450-5 BW450-5 BW450-5 BW450-4	88kg
90kg	BW450-5 BW450-5 BW450-5 BW450-5 BW450-5 BW450-4 BW450-2	94kg
100kg	BW450-5 BW450-5 BW450-5 BW450-5 BW450-5 BW450-5 BW450-3 BW450-2	102kg
105kg	BW450-5 BW450-5 BW450-5 BW450-5 BW450-5 BW450-5 BW450-5 BW450-2	114kg
110kg	BW450-5 BW450-5 BW450-5 BW450-5 BW450-5 BW450-5 BW450-5 BW450-4 BW450-2	122kg
115kg	BW450-5 BW450-5 BW450-5 BW450-5 BW450-5 BW450-5 BW450-5 BW450-5 BW450-2	130kg
120kg	BW450-5 BW450-5 BW450-5 BW450-5 BW450-5 BW450-5 BW450-5 BW450-5 BW450-5 BW450-4 BW450-2	138kg

NOTES:

- BALANCE WEIGHTS AVAILABLE
 - BW450-1 1.0kg
 - BW450-2 2.0kg
 - BW450-3 4.0kg
 - BW450-4 8.0kg
 - BW450-5 16.0kg
- FOR EVERY 1.0kg OF TOP LOAD OVER 20.0kg, ADD 1.38kg OF BALANCE WEIGHTS

REV.	DESCRIPTION	DATE	BY	APP.			
-	SEE SHEET1	-	-	-	COLUMN, FL20MH20-120, 20.0m 8 SIDED MID-HINGED 20kg - 120kg		
					COATING:		
					MAXIMUM LOAD: 1.2m ² 120kg		
					WIND REGION: A, TC 2		GROUND LOAD: M* 111 kNm, V* 10.5 kN
					WEIGHT: 1050kg		DO NOT SCALE
					SHEET 2 OF 2		A4
					DRAWING NO. GA-10835		REVISION 1